

**Anchor point Skylotec Secupin SPA-20-01-300/400/500, installed,
with Würth Screw Anchor W-SA A4 12x100/10**

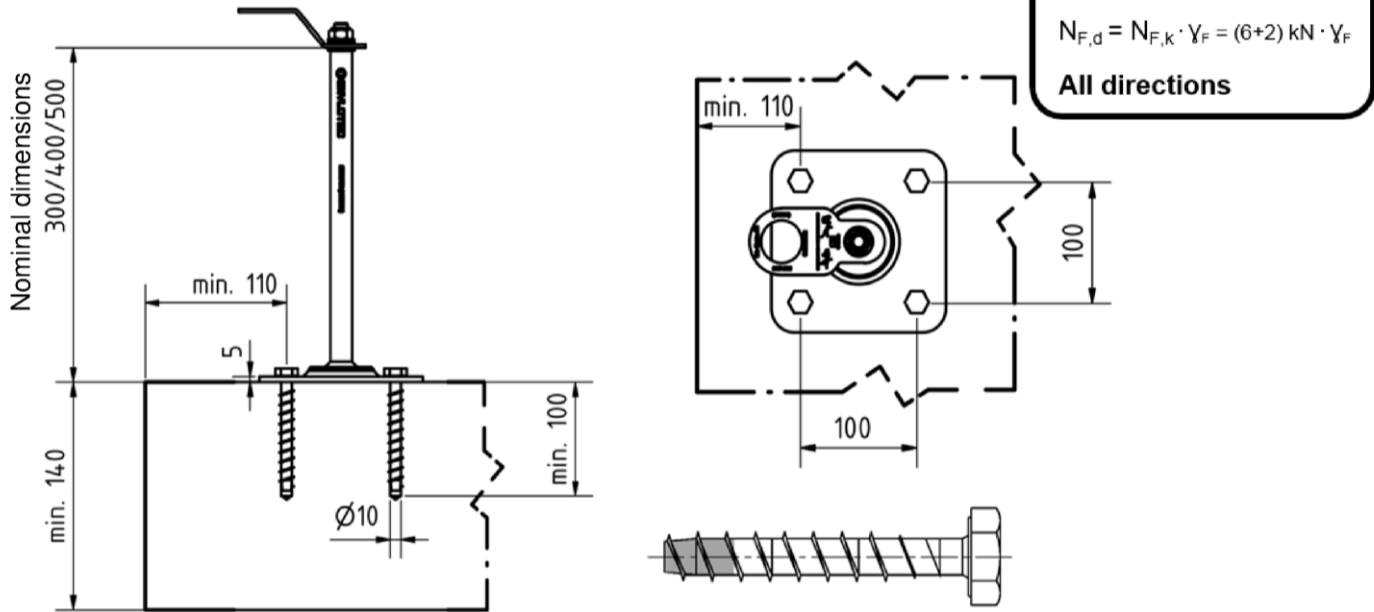

All dimensions in mm.

**Installation instructions for anchor point Skylotec Secupin SPA-20-01-300/400/500
with Würth Screw Anchor W-SA A4 12x100/10**

1		Pay attention to fixing installation instructions and approval (ETA-06/0277). Using a hammer drill, create a bore hole with a drill nominal diameter of $d_o=10$ mm and bore hole depth of $h_1 \geq 100$ mm vertically to the surface of the anchor base
2		Remove the bore dust, e.g. by blowing it out.
3		Insert the screw anchor in the anchor base through the anchor point's 4 through-holes.
4		Manually, or using a tangential impact wrench, secure the screw anchor until the anchor point's base plate is pressed against the concrete base. Recommended torque: 55 Nm.

Skylotec Fall Protection Systems

**SPA-20-01-300/400/500 with Würth Screw Anchor W-SA A4 12 X 100/10
Fitted state/ System components / Installation instructions**

Annex 1